

## REMOVAL

1. **DISCONNECT CABLE FROM NEGATIVE BATTERY TERMINAL**

2. **REMOVE REAR WHEEL**

3. **DRAIN BRAKE FLUID**

HINT:

Immediately wash off any brake fluid that comes into contact with any painted surfaces.

4. **REMOVE REAR DISC BRAKE CALIPER ASSEMBLY**

- (a) Using SST, separate the brake tube.

**SST 09023-00101**

HINT:

Use a container to catch the brake fluid.

- (b) Remove the clip and flexible hose.

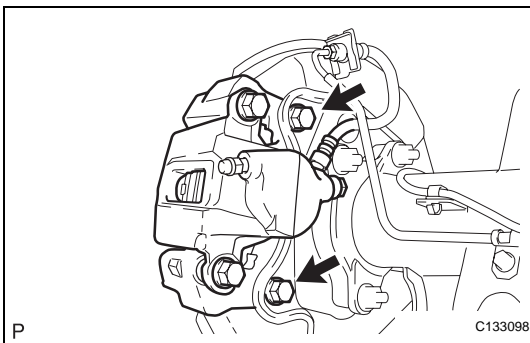
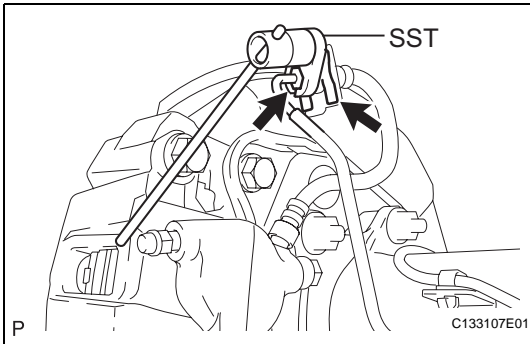

- (c) Remove the 2 bolts and 2 washers and remove the disc brake caliper assembly.

5. **REMOVE REAR DISC (See page PB-17)**

6. **REMOVE PARKING BRAKE SHOE RETURN TENSION SPRING (See page PB-17)**

7. **REMOVE PARKING BRAKE SHOE STRUT (See page PB-17)**

8. **REMOVE PARKING BRAKE SHOE (See page PB-17)**

9. **SEPARATE PARKING BRAKE CABLE**

- (a) Remove the 2 bolts and separate the parking brake cable from the parking brake plate.

10. **REMOVE REAR SPEED SENSOR (See page BC-198)**

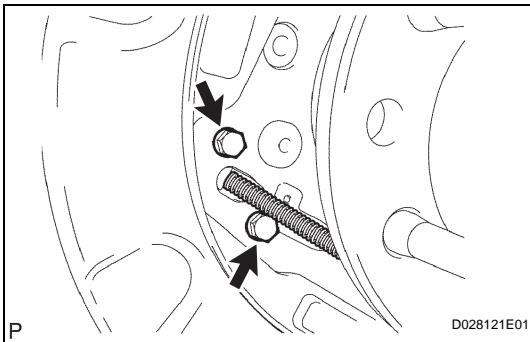

11. **REMOVE REAR AXLE SHAFT**

- (a) Remove the 4 nuts and rear axle shaft with parking brake plate.

- (b) Remove the O-ring.

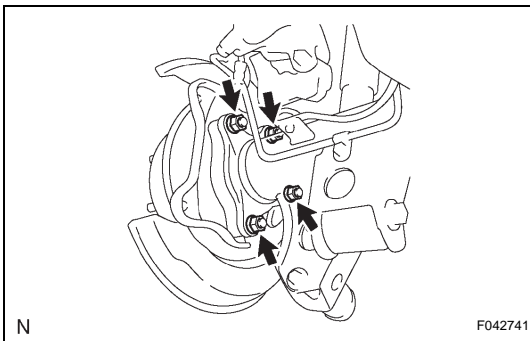

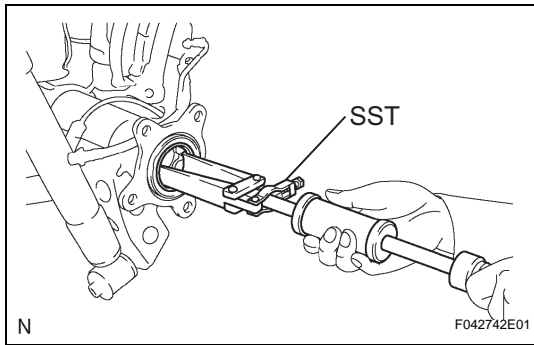

## 12. REMOVE REAR AXLE SHAFT OIL SEAL

- (a) Using SST, remove the oil seal.  
**SST 09308-00010**

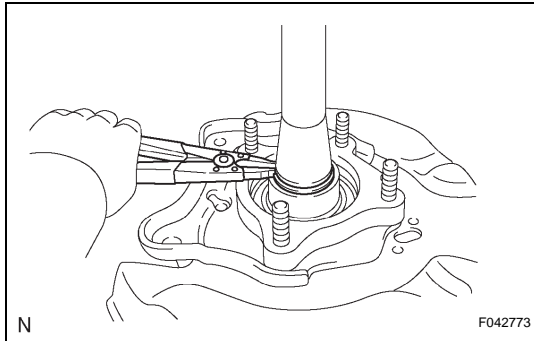

## DISASSEMBLY

### 1. REMOVE REAR AXLE SHAFT SNAP RING

- (a) Using a snap expander, remove the snap ring.

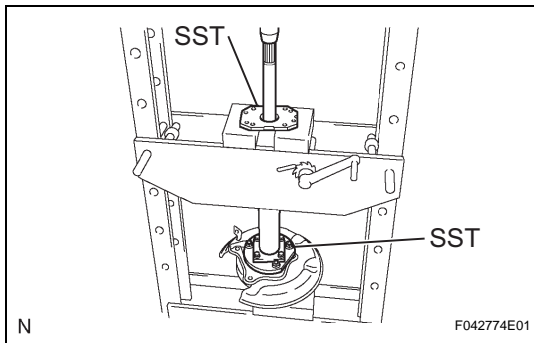

### 2. REMOVE REAR AXLE SHAFT

- (a) Using SST and press, remove the rear axle shaft.  
**SST 09521-25011, 09521-25021**  
 (b) Remove the rear axle bearing inner retainer from the axle hub.  
 (c) Remove the rear axle shaft washer from the axle hub.

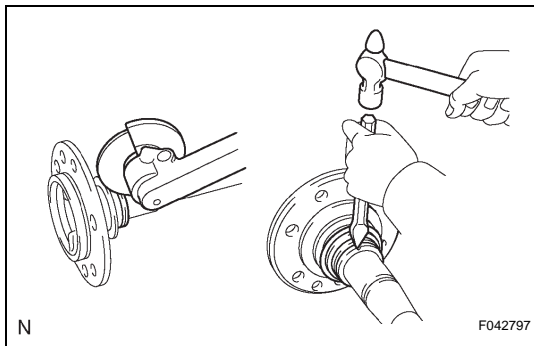

- (d) Grind the rear axle bearing inner race surface using a grinder, then remove it with a chisel.  
 (e) Remove the rear axle shaft oil seal from the rear axle shaft.

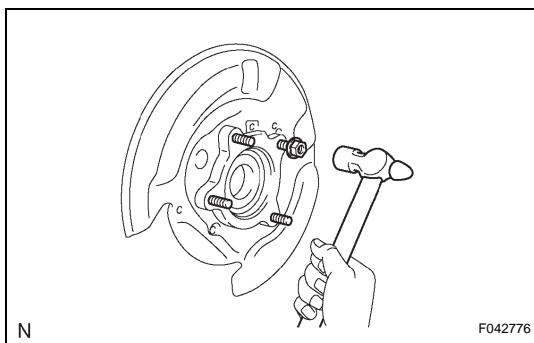

### 3. REMOVE REAR AXLE HUB AND BEARING ASSEMBLY

- (a) Attach the 4 nuts to the housing bolts.  
 (b) Using a hammer, remove the 4 housing bolts and rear axle hub and bearing assembly.

#### NOTICE:

**Do not reuse the nuts previously removed from the vehicle.**